

# G731



## 4-LOBE HANDWHEEL WITH THREADED FEMALE THROUGH INSERT

### Material:

Reinforced polyamide.  
Oils and greases resistant.

### Surface:

Satin.

### Colour:

Black (RAL 9011).

### Main Insert:

Brass right through threaded bush (tolerance 6H).  
(\* ) Zinc plated steel right through threaded bush (tolerance 6H).

### SPECIAL REQUEST:

- It is possible to supply the inserts in different materials, on request and for quantities.
- It is possible to supply colours as shown in the table at pag. G-27, on request and for quantities.

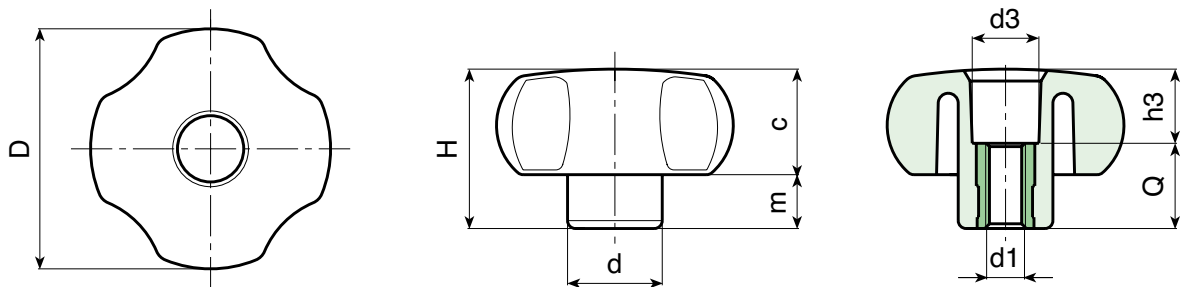

art.	D	H	d	c	m	d3	h3	d1 6H	Q	g
G73120.TM0401	21	14	11	8,5	5,5	8	4,5	M04	9,5	4
G73120.TM0501	21	14	11	8,5	5,5	8	7,5	M05	6,5	5
G73120.TM0601	21	14	11	8,5	5,5	8	7,5	M06	6,5	5
G73125.TM0401	26	16	12	10	6	9	7,5	M08	8,5	5
G73125.TM0501	26	16	12	10	6	9	9,5	M05	6,5	6
G73125.TM0601	26	16	12	10	6	9	9,5	M06	6,5	6
G73125.TM0801	26	16	12	10	6	10,5	1,5	M08	14,5	10
G73130.TM0501	30	23	15	13,5	9,5	12	8,5	M05	14,5	11
G73130.TM0601	30	23	15	13,5	9,5	12	8,5	M06	14,5	11
G73130.TM0801	30	23	15	13,5	9,5	12	8,5	M08	14,5	12
G73130.TM1001	30	23	15	13,5	9,5	12	8,5	M10	14,5	13
G73140.TM0601	40,5	29,5	15,5	18,5	11	13	11,5	M06	18	21
G73140.TM0801	40,5	29,5	15	18,5	11	13	11,5	M08	18	21
G73140.TM1001	40,5	29,5	17,5	18,5	11	13	11,5	M10	18	23
G73140.TM1201	40,5	29,5	21	18,5	11	13	11,5	M12	18	26
G73150.TM0601	49	32	20,5	21,5	11	13,5	14,5	M06	18	37
G73150.TM0801	49	32	20,5	21,5	11	13,5	14,5	M08	18	38
G73150.TM1001	49	32	20,5	21,5	11	13,5	14,5	M10	18	39
G73150.TM1201	49	32	20,5	21,5	11	13,5	14,5	M12	18	40
G73160.TM0801	59	40	23	25	15	20	22	M08	18	54
G73160.TM1001	59	40	23	25	15	20	22	M10	18	55
G73160.TM1201	59	40	23	25	15	20	22	M12	18	55
G73160.TM1401	59	40	23	25	15	20	22	M14	18	56
G73180.TM1001	79	41	30	24	17	20	23	M10	18	82
G73180.TM1201	79	41	30	24	17	20	23	M12	18	79
G73180.TM1401	79	41	30	24	17	20	23	M14	18	80
G73180.TM1601	79	41	30	24	17	21	15	(*) M16	26	102