

# E216

## E221 - E222

# CRANK HANDLE WITH SMOOTH INSERT AND REVOLVING HANDLE

**Material:** Reinforced polyamide. Oils and greases resistant.

**Surface:** Satin.

**Colour:** Black (RAL 9011).

**Central Cap:**

Grey polyamide RAL 7035 (cod. 13).

**Alternative Cap Colour:**

Orange (RAL 2004 cod. 02)

Red (RAL 3000 cod. 16)

Blue (RAL 5015 cod. 07)

Green (RAL 6024 cod. 17)

Yellow (RAL 1021 cod. 10)

Black (RAL 9011 cod. 01)

**Main Insert:**

Zinc plated steel insert with smooth through-hole (H10 tolerance).

**Side Insert:** Brass right through threaded bush.

**Side Handle:**

**E216:** Revolving handle Art. M144

**E221:** Revolving handle Art. M145

**E222:** Revolving handle Art. M129.

**SPECIAL REQUESTS:**

- It is possible to supply the inserts with d1 diameter by customer design, on request and for quantities.
- It is possible to supply the inserts in different materials, on request and for quantities.
- It is possible to supply the inserts in different treatment-finishes, on request and for quantities.
- It is possible to supply arm and handle with colours as shown in the table at pag. 23, on request and for quantities.

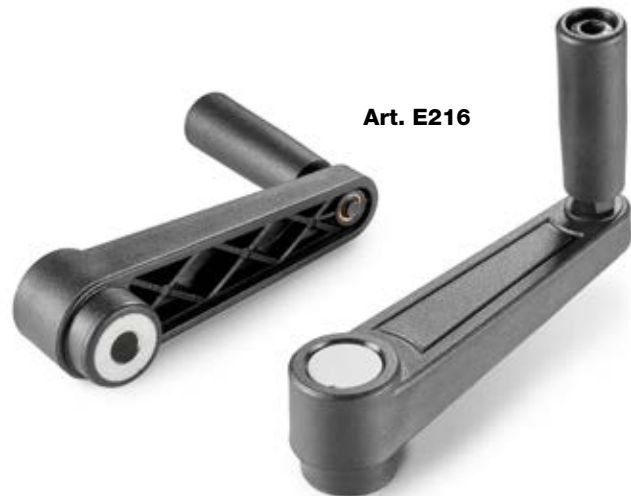

Art. E216



Art. E221



Art. E222

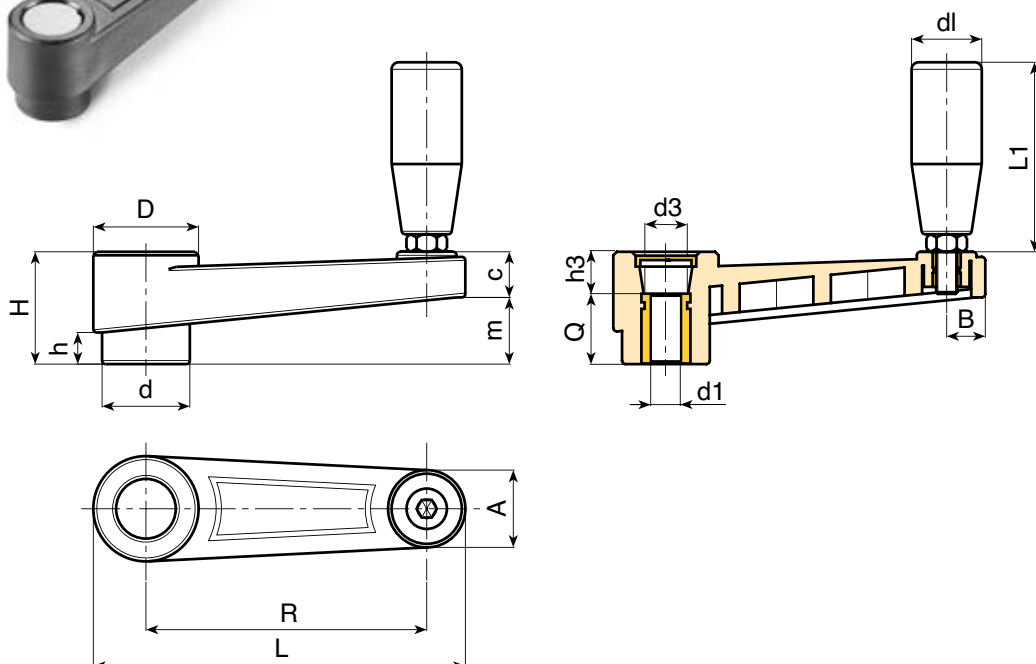

# CRANK HANDLE WITH SMOOTH INSERT AND REVOLVING HANDLE

## E216



Art.	L	R	H	D	d	m	c	A	B	h	d3	h3	dm	d1 H10	Q	dl	L1	g
E216065.TP0501	88	65	30	27	22	17	13	18	9,5	8	14	10	12	05	20	20	56	96
E216065.TD1001	88	65	30	27	22	17	13	18	9,5	8	14	10	12	10	20	20	56	92
E216065.TD1201	88	65	30	27	22	17	13	18	9,5	8	14	10	12	12	20	20	56	89
E216080.TP0501	106	80	33	30	26	19	13	21,5	11	9	18	9	14	05	24	20	56	110
E216080.TD1001	106	80	33	30	26	19	13	21,5	11	9	18	9	14	10	24	20	56	105
E216080.TD1201	106	80	33	30	26	19	13	21,5	11	9	18	9	14	12	24	20	56	102
E216110.TD0801	138	110	39	33	29	22	14	22	12	11	18	11	14	05	28	21	66	160
E216110.TD1001	138	110	39	33	29	22	14	22	12	11	18	11	14	10	28	21	66	152
E216110.TD1201	138	110	39	33	29	22	14	22	12	11	18	11	14	12	28	21	66	148
E216140.TD0801	174	140	49	41	35	34	16	25,5	13,5	15	22	19	20	08	30	23	76	250
E216140.TD1201	174	140	49	41	35	34	16	25,5	13,5	15	22	19	20	12	30	23	76	242
E216140.TD1401	174	140	49	41	35	34	16	25,5	13,5	15	22	19	20	14	30	23	76	238
E216140.TD1601	174	140	49	41	35	34	16	25,5	13,5	15	22	19	20	16	30	23	76	232
E216185.TD0801	220	185	55	45	40	40	16,5	26,5	14	16,5	28	21	22	08	34	25	86	430
E216185.TD1201	220	185	55	45	40	40	16,5	26,5	14	16,5	28	21	22	12	34	25	86	400

dm = It's possible to increase the hole, by boring, until Dm (enlarge).

# CRANK HANDLE WITH SMOOTH INSERT AND REVOLVING HANDLE M145

## E221



Art.	L	R	H	D	d	m	c	A	B	h	d3	h3	dm	d1 H10	Q	dl	L1	g
E221065.TP0501	88	65	30	27	22	17	13	18	9,5	8	14	10	12	05	20	20	56	101
E221065.TD1001	88	65	30	27	22	17	13	18	9,5	8	14	10	12	10	20	20	56	107
E221065.TD1201	88	65	30	27	22	17	13	18	9,5	8	14	10	12	12	20	20	56	104
E221080.TP0501	106	80	33	30	26	19	13	21,5	11	9	18	9	14	05	24	20	56	125
E221080.TD1001	106	80	33	30	26	19	13	21,5	11	9	18	9	14	10	24	20	56	130
E221080.TD1201	106	80	33	30	26	19	13	21,5	11	9	18	9	14	12	24	20	56	127
E221110.TD0801	138	110	39	33	29	22	14	22	12	11	18	11	14	05	28	23	66	175
E221110.TD1001	138	110	39	33	29	22	14	22	12	11	18	11	14	10	28	23	66	172
E221110.TD1201	138	110	39	33	29	22	14	22	12	11	18	11	14	12	28	23	66	169
E221140.TD0801	174	140	49	41	35	34	16	25,5	13,5	15	22	19	20	08	30	25	77	263
E221140.TD1201	174	140	49	41	35	34	16	25,5	13,5	15	22	19	20	12	30	25	77	257
E221140.TD1401	174	140	49	41	35	34	16	25,5	13,5	15	22	19	20	14	30	25	77	253
E221140.TD1601	174	140	49	41	35	34	16	25,5	13,5	15	22	19	20	16	30	25	77	249
E221185.TD0801	220	185	55	45	40	40	16,5	26,5	14	16,5	28	21	22	08	34	25	87	440
E221185.TD1201	220	185	55	45	40	40	16,5	26,5	14	16,5	28	21	22	12	34	25	87	433

dm = It's possible to increase the hole, by boring, until Dm (enlarge).

# CRANK HANDLE WITH SMOOTH INSERT AND REVOLVING HANDLE M129

## E222



Art.	L	R	H	D	d	m	c	A	B	h	d3	h3	dm	d1 H10	Q	dl	L1	g
E222065.TP0501	88	65	30	27	22	17	13	18	9,5	8	14	10	12	05	20	20	52	111
E222065.TD1001	88	65	30	27	22	17	13	18	9,5	8	14	10	12	10	20	20	52	117
E222065.TD1201	88	65	30	27	22	17	13	18	9,5	8	14	10	12	12	20	20	52	114
E222080.TP0501	106	80	33	30	26	19	13	21,5	11	9	18	9	14	05	24	20	52	135
E222080.TD1001	106	80	33	30	26	19	13	21,5	11	9	18	9	14	10	24	20	52	140
E222080.TD1201	106	80	33	30	26	19	13	21,5	11	9	18	9	14	12	24	20	52	136
E222110.TD0801	138	110	39	33	29	22	14	22	12	11	18	11	14	08	28	23	62	182
E222110.TD1001	138	110	39	33	29	22	14	22	12	11	18	11	14	10	28	23	62	179
E222110.TD1201	138	110	39	33	29	22	14	22	12	11	18	11	14	12	28	23	62	175
E222140.TD0801	174	140	49	41	35	34	16	25,5	13,5	15	22	19	20	08	30	25	72	271
E222140.TD1201	174	140	49	41	35	34	16	25,5	13,5	15	22	19	20	12	30	25	72	265
E222140.TD1401	174	140	49	41	35	34	16	25,5	13,5	15	22	19	20	14	30	25	72	261
E222140.TD1601	174	140	49	41	35	34	16	25,5	13,5	15	22	19	20	16	30	25	72	255
E222185.TD0801	220	185	55	45	40	40	16,5	26,5	14	16,5	28	21	22	08	34	25	82	450
E222185.TD1201	220	185	55	45	40	40	16,5	26,5	14	16,5	28	21	22	12	34	25	82	442

dm = It's possible to increase the hole, by boring, until Dm (enlarge).

Presumable presence in the stock in %

( ) 90% (●) 40% (●) 5% (●) |

BOTECO® - © All right reserved - www.boteco.it

Any unauthorized reproduction is strictly forbidden



BOTECO

**E - FIXED AND INDEXED CRANK HANDLES**