

D207



2 SPOKE CONTROL HANDWHEEL WITH REVOLVING FOLDAWAY HANDLE

Material:

Reinforced and stabilised polyamide.
Oils and greases resistant.

Surface:

Satin.

Colour:

Black (RAL 9011).

Central Cap:

Grey polyamide (RAL 7035 cod. 13).

Alternative Cap Colour:

- Orange (RAL 2004 cod. 02)
- Blue (RAL 5015 cod. 07)
- Yellow (RAL 1021 cod. 10)
- Red (RAL 3000 cod. 16)
- Green (RAL 6024 cod. 17)
- Black (RAL 9011 cod. 01)

Main Insert:

Zinc plated steel insert with smooth through-hole (H10 tolerance).

Side handle:

Flush, foldaway revolving handle, with hexagonal connection. Reinforced polyamide. Black-oxide treated internal mechanism. Fixed with black-oxide treated hexagon socket button head screw ISO 7838.

Hub:

Solid hub.

For fixing system, or execution of keyway or square holes, please refer to the technical notes attached to the catalogue.

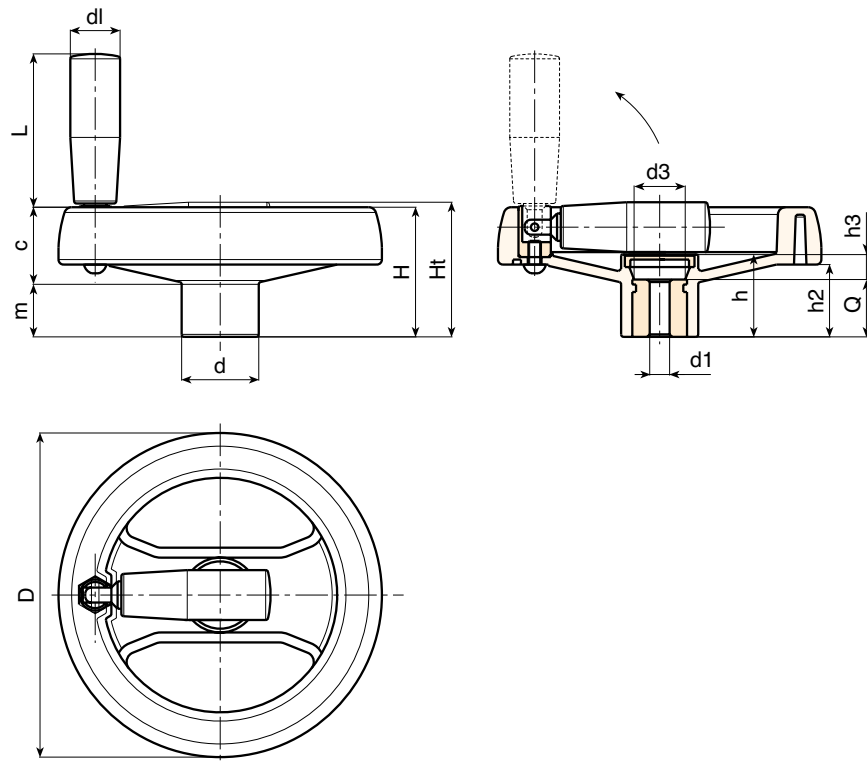

SPECIAL REQUEST:

- It's possible to supply the inserts with d1 bore by customer design, on request and for quantities.
- It's possible to supply the inserts in different material and treatment-finishes, on request and for quantities.
- It's possible to supply the products with colours (reduced range) as shown in the table at page D-19, on request and for quantities.



Version with zinc plated insert and H10 tolerance bore

Art.	D	H	Ht	h	d	m	c	h2	h3	d3	dl	L	Dm	d1 H10	Q	g
D207130.TP0501P	129	53	55	32	32	22	31	30	12	26	20	58	18	05	20	300
D207130.TD0801P	129	53	55	32	32	22	31	30	12	26	20	58	18	08	20	297
D207130.TD1201P	129	53	55	32	32	22	31	30	12	26	20	58	18	12	20	294
D207160.TP0501P	159	55	59	33,5	40	20,5	34,5	31	9,5	26	25	71	22	05	24	450
D207160.TD0801P	159	55	59	33,5	40	20,5	34,5	31	9,5	26	25	71	22	08	24	447
D207160.TD1201P	159	55	59	33,5	40	20,5	34,5	31	9,5	26	25	71	22	12	24	443
D207160.TD1401P	159	55	59	33,5	40	20,5	34,5	31	9,5	26	25	71	22	14	24	440
D207160.TD1601P	159	55	59	33,5	40	20,5	34,5	31	9,5	26	25	71	22	16	24	436
D207350.TD0801P	346	80	86	49,5	67,5	24	56	43,5	17,5	35	40	64	30	08	32	1650

Attention: bore d1 (H10 tolerance) could be produced by request, with 50 pieces minimum.

Dm = It's possible to increase the hole, by boring, until Dm (enlarge).